

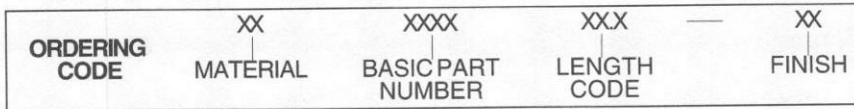

13mm HEX MALE-FEMALE STANDOFFS

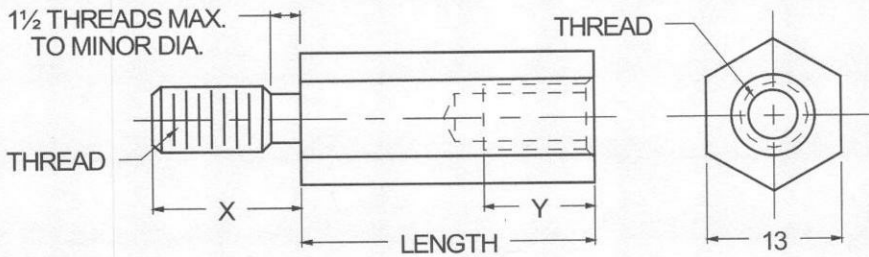

| MATERIAL | CODE |
|-----------------|------|
| BRASS | BR |
| ALUMINUM | AL |
| STAINLESS STEEL | SS |

NOTE: See Page B2 for additional materials and specifications.

| THREAD SIZE | BASIC PART NO. |
|-------------|----------------|
| M5.0 x 0.8 | 5181 |
| M6.0 x 1.0 | 5182 |
| M8.0 x 1.25 | 5183 |

NOTE: Variance in sizes between male and female threads are available.

| LENGTH mm | CODE | LENGTH mm | CODE |
|-----------|------|-----------|------|
| 6 | 06.0 | 29 | 29.0 |
| 8 | 08.0 | 30 | 30.0 |
| 10 | 10.0 | 32 | 32.0 |
| 11 | 11.0 | 33 | 33.0 |
| 12 | 12.0 | 35 | 35.0 |
| 13 | 13.0 | 37 | 37.0 |
| 14 | 14.0 | 38 | 38.0 |
| 16 | 16.0 | 40 | 40.0 |
| 19 | 19.0 | 41 | 41.0 |
| 20 | 20.0 | 44 | 44.0 |
| 22 | 22.0 | 45 | 45.0 |
| 25 | 25.0 | 48 | 48.0 |
| 27 | 27.0 | 51 | 51.0 |

NOTE: For lengths not listed, contact Lyn-Tron, Inc.

| THREAD SIZE | "X" LENGTH | "Y" MIN. FULL THD. DEPTH | MIN. BODY LENGTH |
|-------------|------------|--------------------------|------------------|
| M5.0 x 0.8 | 9.53 | 12.7 | 16.5 |
| M6.0 x 1.0 | 12.7 | 16.0 | 20.0 |
| M8.0 x 1.25 | 12.7 | 16.0 | 21.0 |

- NOTES:
- See page B2 for recommended "Y" thread depth where length is less than minimum body length shown on chart to left.
 - Threads longer or shorter than "X" length are available.

| CODE | FINISH | CODE | FINISH |
|------|--|------|--|
| 00 | Plain — None | 33 | Black Zinc |
| 01 | Passivate MIL-F-14072-E300 | 34* | Zinc QQ-Z-325, Type II, CL 3 — Clear Chromate |
| 02 | Caustic Etch | 35 | Zinc QQ-Z-325, Type I, CL 3 |
| 03 | Bright Dip — Brass | 36 | Zinc QQ-Z-325, Type II, CL 3 — Yellow Chromate |
| 11 | Anodize MIL-A-8625C, Type I | 42 | Electro Tin MIL-T-10727, Type I (Dull) |
| | Chromic Hot Water Seal — Dark Grey | 43 | Electro Tin MIL-T-10727 C, Type I (Bright) |
| 12 | Anodize MIL-A-8625C, Type II | 44 | Electro Tin (Solder) MIL-F-14072 M230/M222 |
| | Sulphuric Hot Water Seal — Clear | 48 | Copper / Nickel / Bright Tin |
| 13 | Anodize MIL-A-8625C, Type II | 50 | Black Oxide MIL-C-13924 — Steel |
| | Sulphuric Dichromate Seal — Yellow Green | 51 | Black Oxide MIL-F-495 — Brass |
| 14 | Anodize MIL-A-8625C — Black | 52 | Black Oxide MIL-C-13924 — Stainless Steel |
| 21 | Iridite MIL-C-5541 — Clear | 61 | Nickel QQ-N-290 CL 1, Type VI KC |
| 22* | Iridite MIL-C-5541 — Gold #14 | 63 | Ductile Nickel |
| 31 | Cadmium QQ-P-416, CL 2 — Clear Chromate | 66 | Electroless Nickel |
| 32 | Cadmium QQ-P-416, CL 2 — Color Chromate | 91 | Silver QQ-S-365 |

*Standard finishes: Zinc (Clear Chromate) on brass material, Iridite (Gold #14) on aluminum material.