

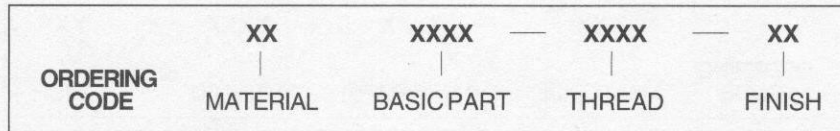

# 5/16 ROUND HANDLES INTERNAL THREAD

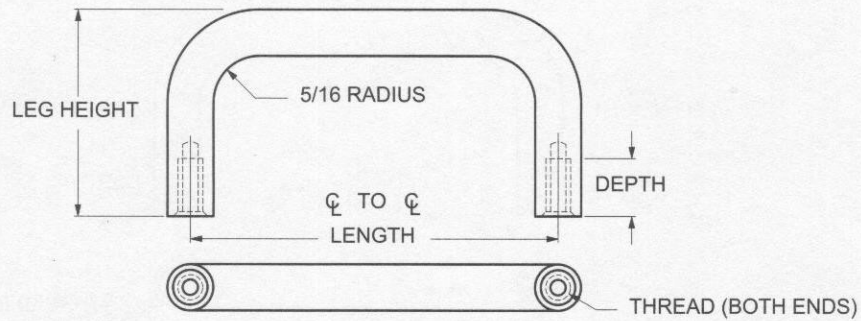

MATERIAL		CODE	LENGTH ¢ TO ¢ ±1/32	LEG HEIGHT ±1/32	BASIC PART NUMBER	LENGTH ¢ TO ¢ ±1/32	LEG HEIGHT ±1/32	BASIC PART NUMBER
ALUMINUM		AL	2"	1-5/16	1158	5-1/2	1-1/2	1189
BRASS		BR	2-1/4		1159	5-3/4		1190
STAINLESS STEEL		SS	2-1/2		1160	6"		1191
STEEL		ST	2-3/4		1161	6-7/16		1192
			2-13/16		1162	6-1/2		1193
			3"		1163	7"	1194	
			4"		1164			
			4-1/4		1165			
			2"	1-3/8	1166	3"	1-3/4	1195
			2-1/2		1167	3-1/2		1196
			3"		1168	4"		1197
			4"		1169	4-1/4		1198
			4-1/4		1170	4-1/2		1199
			5"	1171	4-9/16	1200		
			2"		4-5/8	1201		
			2-1/8		4-3/4	1202		
			2-1/4		5"	1203		
			2-3/8		5-1/8	1204		
			2-1/2		5-1/4	1205		
			2-3/4		5-1/2	1206		
			3"		5-3/4	1207		
			3-1/8	1-1/2	1172	6"	1208	
			3-1/4		1173	6-1/4	1209	
			3-1/2		1174	6-7/16	1210	
			4"		1175	6-1/2	1211	
			4-1/4		1176	6-3/4	1212	
			4-1/2		7"	1213		
			5"					
			6"					
			2"		1177			
			2-1/2		1178			
			3"		1179			
			3-1/2		1180			
			4"		1181			
			4-1/4		1182			
			4-1/2		1183			
			4-9/16		1184			
			5"		1185			
			5-1/4		1186			
					1187			
					1188			

CODE	FINISH	CODE	FINISH
00	Plain — None	19	Bright Anodize — Black (High Luster)
01	Passivate MIL-F-14072-E300	21	Iridite MIL-C-5541 — Clear
02	Caustic Etch	22	Iridite MIL-C-5541 — Gold #14
12	Anodize MIL-A-8625C, Type II Sulphuric Hot Water Seal — Clear	34	Zinc QQ-Z-325, Type II, CL 3 — Clear Chromate
13	Anodize MIL-A-8625C, Type II Sulphuric Dichromate Seal — Yellow Green	36	Zinc QQ-Z-325, Type II, CL 3 — Yellow Chromate
14	Anodize MIL-A-8625C — Black	51	Black Oxide MIL-F-495 — Brass
15	Semi-Frost Anodize — Clear	52	Black Oxide MIL-C-13924 — Stainless Steel
16	Semi-Frost Anodize — Black	61	Nickel QQ-N-290 CL 1, Type VI KC
17	Satin Anodize — Clear	62	Black Nickel
18	Satin Anodize — Black	71	Chrome QQ-C-320 CL 1, Type 1 — Bright
		72	Chrome QQ-C-320 CL 1, Type 1 — Satin