

# 3/8 ROUND HANDLES INTERNAL THREAD

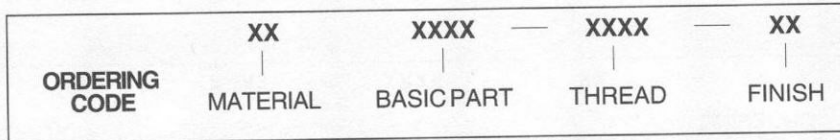
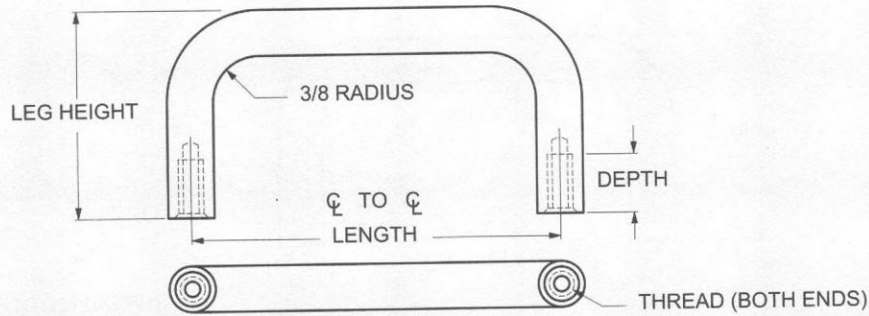

MATERIAL	CODE
ALUMINUM	AL
BRASS	BR
STAINLESS STEEL	SS
STEEL	ST

THREAD SIZE	CODE	THREAD DEPTH
8-32	0832	7/16
10-32	1032	7/16-5/8
1/4-20	2520	3/8-5/8

LENGTH ℄ TO ℄ ±1/32	LEG HEIGHT ±1/32	BASIC PART NUMBER
2"	1-5/16	1214
3"		1215
4"		1216
5"		1217
6"		1218
7"		1219
2-1/2"		1-1/2
3"	1221	
4"	1222	
4-1/4"	1223	
4-1/2"	1224	
5"	1225	
6"	1226	
7"	1227	

LENGTH ℄ TO ℄ ±1/32	LEG HEIGHT ±1/32	BASIC PART NUMBER
2"	1-3/4	1228
2-1/2"		1229
3"		1230
3-1/2"		1231
4"		1232
4-1/4"		1233
4-1/2"		1234
5"		1235
5-1/4"		1236
5-1/2"		1237
5-3/4"		1238
6"	1239	
6-1/2"	1240	
7"	1241	
3"	1-7/8	1242
4"		1243
4-1/4"		1244
4-1/2"		1245
5"		1246
6"		1247

CODE	FINISH	CODE	FINISH
00	Plain — None	19	Bright Anodize — Black (High Luster)
01	Passivate MIL-F-14072-E300	21	Iridite MIL-C-5541 — Clear
02	Caustic Etch	22	Iridite MIL-C-5541 — Gold #14
12	Anodize MIL-A-8625C, Type II Sulphuric Hot Water Seal — Clear	34	Zinc QQ-Z-325, Type II, CL 3 — Clear Chromate
13	Anodize MIL-A-8625C, Type II Sulphuric Dichromate Seal — Yellow Green	36	Zinc QQ-Z-325, Type II, CL 3 — Yellow Chromate
14	Anodize MIL-A-8625C — Black	51	Black Oxide MIL-F-495 — Brass
15	Semi-Frost Anodize — Clear	52	Black Oxide MIL-C-13924 — Stainless Steel
16	Semi-Frost Anodize — Black	61	Nickel QQ-N-290 CL 1, Type VI KC
17	Satin Anodize — Clear	62	Black Nickel
18	Satin Anodize — Black	71	Chrome QQ-C-320 CL 1, Type 1 — Bright
		72	Chrome QQ-C-320 CL 1, Type 1 — Satin