

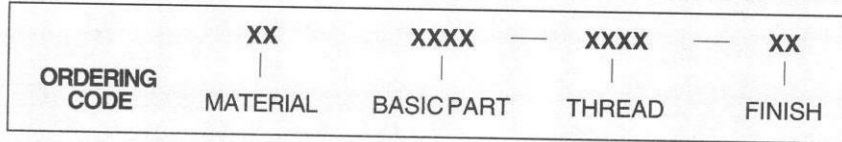

3/16 ROUND HANDLES INTERNAL THREAD

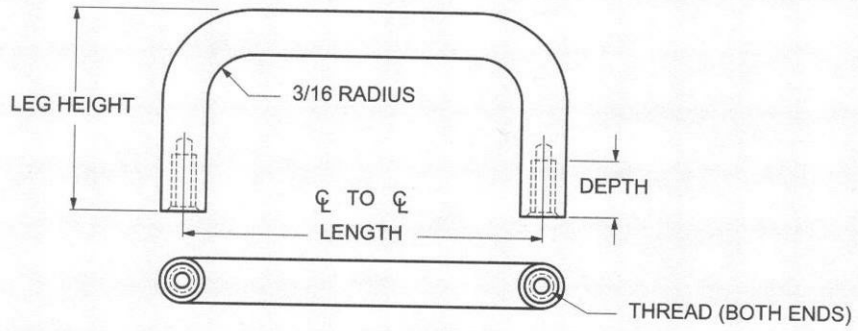

MATERIAL	CODE
ALUMINUM	AL
BRASS	BR
STAINLESS STEEL	SS
STEEL	ST

THREAD SIZE	CODE	THREAD DEPTH
4-40	0440	1/4
6-32	0632	5/16-3/8

LENGTH ¢ TO ¢ ±1/32	LEG HEIGHT ±1/32	BASIC PART NUMBER
1-1/2	5/8	1048
1-3/4		1049
2"		1050
3"		1051
4"		1052
5"	1053	
1"	3/4	1054
1-1/4		1055
1-1/2		1056
1-3/4		1057
2"		1058
3"		1059
4"		1060
5"	1061	

LENGTH ¢ TO ¢ ±1/32	LEG HEIGHT ±1/32	BASIC PART NUMBER
1"	7/8	1062
1-1/4		1063
1-1/2		1064
1-3/4		1065
2"		1066
3"		1067
4"	1068	
5"	1069	
1"	1"	1070
1-1/4		1071
1-1/2		1072
1-3/4		1073
2"		1074
3"		1075
4"	1076	
5"	1077	
1"	1-1/8	1078
1-1/4		1079
1-1/2		1080
1-3/4		1081
2"		1082
3"		1083
4"	1084	
5"	1085	

LENGTH ¢ TO ¢ ±1/32	LEG HEIGHT ±1/32	BASIC PART NUMBER
1"	1-1/4	1086
1-1/4		1087
1-1/2		1088
1-3/4		1089
2"		1090
3"	1091	
4"	1092	
5"	1093	
1"	1-1/2	1094
1-1/4		1095
1-1/2		1096
1-3/4		1097
2"		1098
3"		1099
4"		1100
5"	1101	

CODE	FINISH	CODE	FINISH
00	Plain — None	19	Bright Anodize — Black (High Luster)
01	Passivate MIL-F-14072-E300	21	Iridite MIL-C-5541 — Clear
02	Caustic Etch	22	Iridite MIL-C-5541 — Gold #14
12	Anodize MIL-A-8625C, Type II Sulphuric Hot Water Seal — Clear	34	Zinc QQ-Z-325, Type II, CL 3 — Clear Chromate
13	Anodize MIL-A-8625C, Type II Sulphuric Dichromate Seal — Yellow Green	36	Zinc QQ-Z-325, Type II, CL 3 — Yellow Chromate
14	Anodize MIL-A-8625C — Black	51	Black Oxide MIL-F-495 — Brass
15	Semi-Frost Anodize — Clear	52	Black Oxide MIL-C-13924 — Stainless Steel
16	Semi-Frost Anodize — Black	61	Nickel QQ-N-290 CL 1, Type VI KC
17	Satin Anodize — Clear	62	Black Nickel
18	Satin Anodize — Black	71	Chrome QQ-C-320 CL 1, Type 1 — Bright
		72	Chrome QQ-C-320 CL 1, Type 1 — Satin