

# 1/4 ROUND OFFSET HANDLES INTERNAL THREAD

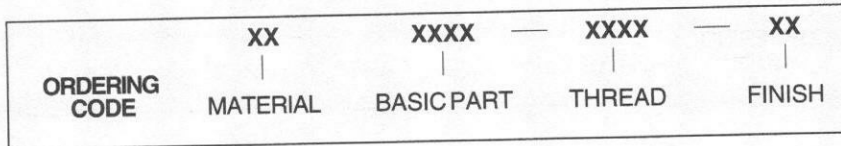
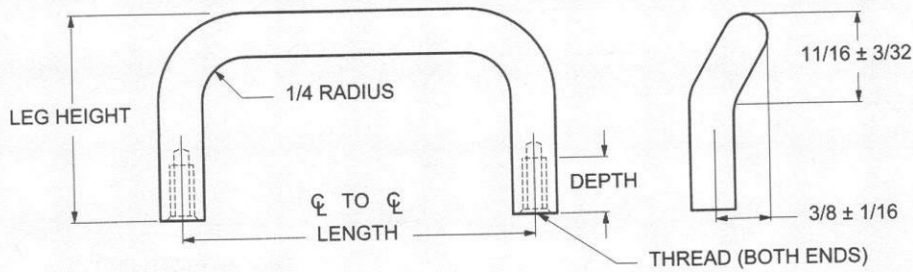

MATERIAL	CODE
ALUMINUM	AL
BRASS	BR
STAINLESS STEEL	SS
STEEL	ST

THREAD SIZE	CODE	THREAD DEPTH
6-32	0632	5/16-7/16
8-32	0832	5/16-7/16

LENGTH ¢ TO ¢ ±1/32	LEG HEIGHT ±1/32	BASIC PART NUMBER
2"	1"	1260
3"		1261
4"		1262
4-1/2"		1263
5"		1264
6"		1265
2"	1-1/2"	1266
3"		1267
4"		1268
4-1/2"		1269
5"		1270
5-1/2"		1271
6"	1272	
2"	2"	1273
3"		1274
4"		1275
4-1/2"		1276
5"		1277
6"		1278

CODE	FINISH	CODE	FINISH
00	Plain — None	19	Bright Anodize — Black (High Luster)
01	Passivate MIL-F-14072-E300	21	Iridite MIL-C-5541 — Clear
02	Caustic Etch	22	Iridite MIL-C-5541 — Gold #14
12	Anodize MIL-A-8625C, Type II	34	Zinc QQ-Z-325, Type II, CL 3 — Clear Chromate
	Sulphuric Hot Water Seal — Clear	36	Zinc QQ-Z-325, Type II, CL 3 — Yellow Chromate
13	Anodize MIL-A-8625C, Type II	51	Black Oxide MIL-F-495 — Brass
	Sulphuric Dichromate Seal — Yellow Green	52	Black Oxide MIL-C-13924 — Stainless Steel
14	Anodize MIL-A-8625C — Black	61	Nickel QQ-N-290 CL 1, Type VI KC
15	Semi-Frost Anodize — Clear	62	Black Nickel
16	Semi-Frost Anodize — Black	71	Chrome QQ-C-320 CL 1, Type 1 — Bright
17	Satin Anodize — Clear	72	Chrome QQ-C-320 CL 1, Type 1 — Satin
18	Satin Anodize — Black		