

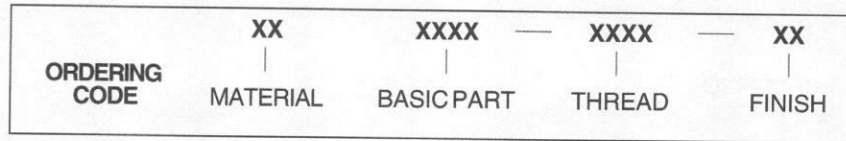

7/16 X 9/32 OVAL HANDLES INTERNAL THREAD

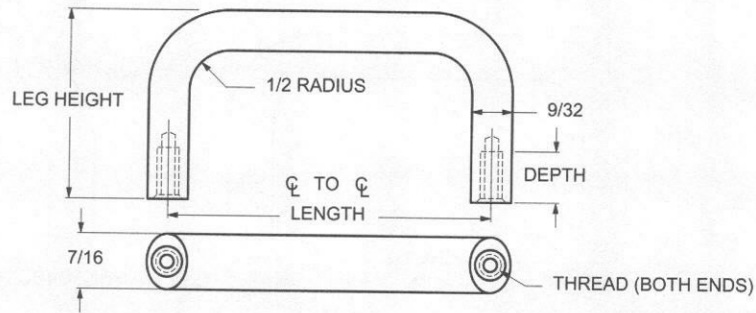

MATERIAL	CODE
ALUMINUM	AL
BRASS	BR

THREAD SIZE	CODE	THREAD DEPTH
8-32	0832	5/16-1/2
10-24	1024	5/16-5/8
10-32	1032	5/16-5/8

LENGTH ¢ TO ¢ ±1/32	LEG HEIGHT ±1/32	BASIC PART NUMBER
2"		1317
2-1/2		1318
3"		1319
4"		1320
4-1/4	1"	1321
4-1/2		1322
4-9/16		1323
5"		1324
6"		1325
6-7/16		1326

LENGTH ¢ TO ¢ ±1/32	LEG HEIGHT ±1/32	BASIC PART NUMBER
2"		1327
2-1/4		1328
2-1/2		1329
3"	1-9/32	1330
3-1/2		1331
4"		1332
4-1/4		1333
4-1/2		1334
4-9/16		1335
6"		1336
2"		1337
2-1/4		1338
2-1/2		1339
3"		1340
3-1/2	1-1/2	1341
4"		1342
4-1/4		1343
4-1/2		1344
4-9/16		1345
5"		1346
6"		1347

CODE	FINISH	CODE	FINISH
00	Plain — None	19	Bright Anodize — Black (High Luster)
01	Passivate MIL-F-14072-E300	21	Iridite MIL-C-5541 — Clear
02	Caustic Etch	22	Iridite MIL-C-5541 — Gold #14
12	Anodize MIL-A-8625C, Type II Sulphuric Hot Water Seal — Clear	34	Zinc QQ-Z-325, Type II, CL 3 — Clear Chromate
13	Anodize MIL-A-8625C, Type II Sulphuric Dichromate Seal — Yellow Green	36	Zinc QQ-Z-325, Type II, CL 3 — Yellow Chromate
14	Anodize MIL-A-8625C — Black	51	Black Oxide MIL-F-495 — Brass
15	Semi-Frost Anodize — Clear	52	Black Oxide MIL-C-13924 — Stainless Steel
16	Semi-Frost Anodize — Black	61	Nickel QQ-N-290 CL 1, Type VI KC
17	Satin Anodize — Clear	62	Black Nickel
18	Satin Anodize — Black	71	Chrome QQ-C-320 CL 1, Type 1 — Bright
		72	Chrome QQ-C-320 CL 1, Type 1 — Satin